

RAM® QUICK DRAW™ ASSEMBLY INSTRUCTIONS (SIDE A)

PARTS INDEX:

- A. RAM® QUICK DRAW™ (QTY. 1)
- B. DOCKING CUP (QTY. 1)
- C. TOP CUP (QTY. 1)
- D. #6-32 X 1/2" MACHINE SCREW (QTY. 8)
- E. #6-32 NYLOCK NUT (QTY. 8)

SUGGESTED TOOLS:

- 5/16" HEX WRENCH
- #2 PHILIPS HEAD SCREWDRIVER



DOCKING CUP AND TOP CUP MAY VARY BASED ON HAND-HELD DEVICE.

STEP 1 - ATTACH TOP CUP

ATTACH (C) TOP CUP TO (A) QUICK DRAW™ USING 4 (D) SCREWS AND 4 (E) NUTS SO THAT OPENING OF TOP CUP FACES THE LENGTH OF THE QUICK DRAW AS SHOWN. SCREWS SHOULD BE INSERTED UPWARD TOWARDS (C) TOP CUP.

STEP 2 - ATTACH DOCKING CUP

ATTACH (B) DOCKING CUP TO (A) QUICK DRAW™ USING 4 (D) SCREWS AND 4 (E) NUTS SO THAT DEVICE EXTENDS THE (C) TOP CUP 1/2" TO 1" WHILE DOCKED (SEE TENSION ADJUSTMENT). SCREWS SHOULD BE INSERTED DOWNWARD TOWARDS QUICK DRAW SPINE.

TENSION ADJUSTMENT

THE PLACEMENT OF THE (B) DOCKING CUP CAN BE ADJUSTED TO FIT VARIOUS ACCESSORIES. SLOTTED HOLES ALONG (A) QUICK DRAW™ SPINE ALLOW SCREWS AND NUTS TO BE ATTACHED TO ADJUST FOR VARIOUS HEIGHTS. THE GOAL IS TO PROVIDE SPRING TENSION, BASED ON THE OVERALL LENGTH OF THE DEVICE, INCLUDING ATTACHED ACCESSORIES. IT IS IMPORTANT TO ADJUST DOCK SO THAT DEVICE HAS ADEQUATE SPRING TENSION TO FORCE (C) TOP CUP AND DEVICE DOWN ONTO THE (B) DOCKING CUP. THIS IS CRITICAL FOR PROPER FUNCTIONALITY. DEVICE SHOULD NOT SHAKE OR RATTLE WHILE DOCKED.

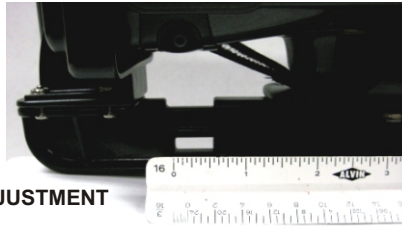
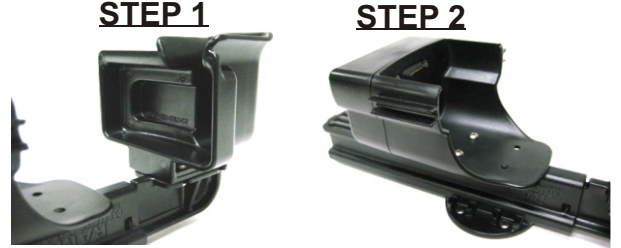

TENSION ADJUSTMENT

RAM Mounting Systems

8410 Dallas Ave S
Seattle, WA 98108
Phone: (206) 763-8361
Fax: (206) 763-9615
www.rammount.com
support@rammount.com



This document, including images, may not be reproduced partly or fully without the expressed written consent of National Products, Inc.

RAM® QUICK DRAW™ ASSEMBLY INSTRUCTIONS (SIDE A)

PARTS INDEX:

- A. RAM® QUICK DRAW™ (QTY. 1)
- B. DOCKING CUP (QTY. 1)
- C. TOP CUP (QTY. 1)
- D. #6-32 X 1/2" MACHINE SCREW (QTY. 8)
- E. #6-32 NYLOCK NUT (QTY. 8)

SUGGESTED TOOLS:

- 5/16" HEX WRENCH
- #2 PHILIPS HEAD SCREWDRIVER



DOCKING CUP AND TOP CUP MAY VARY BASED ON HAND-HELD DEVICE.

STEP 1 - ATTACH TOP CUP

ATTACH (C) TOP CUP TO (A) QUICK DRAW™ USING 4 (D) SCREWS AND 4 (E) NUTS SO THAT OPENING OF TOP CUP FACES THE LENGTH OF THE QUICK DRAW AS SHOWN. SCREWS SHOULD BE INSERTED UPWARD TOWARDS (C) TOP CUP.

STEP 2 - ATTACH DOCKING CUP

ATTACH (B) DOCKING CUP TO (A) QUICK DRAW™ USING 4 (D) SCREWS AND 4 (E) NUTS SO THAT DEVICE EXTENDS THE (C) TOP CUP 1/2" TO 1" WHILE DOCKED (SEE TENSION ADJUSTMENT). SCREWS SHOULD BE INSERTED DOWNWARD TOWARDS QUICK DRAW SPINE.

TENSION ADJUSTMENT

THE PLACEMENT OF THE (B) DOCKING CUP CAN BE ADJUSTED TO FIT VARIOUS ACCESSORIES. SLOTTED HOLES ALONG (A) QUICK DRAW™ SPINE ALLOW SCREWS AND NUTS TO BE ATTACHED TO ADJUST FOR VARIOUS HEIGHTS. THE GOAL IS TO PROVIDE SPRING TENSION, BASED ON THE OVERALL LENGTH OF THE DEVICE, INCLUDING ATTACHED ACCESSORIES. IT IS IMPORTANT TO ADJUST DOCK SO THAT DEVICE HAS ADEQUATE SPRING TENSION TO FORCE (C) TOP CUP AND DEVICE DOWN ONTO THE (B) DOCKING CUP. THIS IS CRITICAL FOR PROPER FUNCTIONALITY. DEVICE SHOULD NOT SHAKE OR RATTLE WHILE DOCKED.

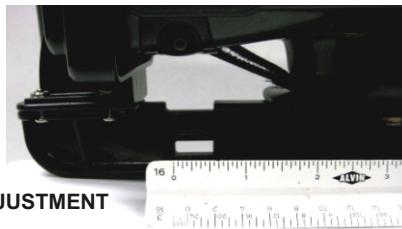
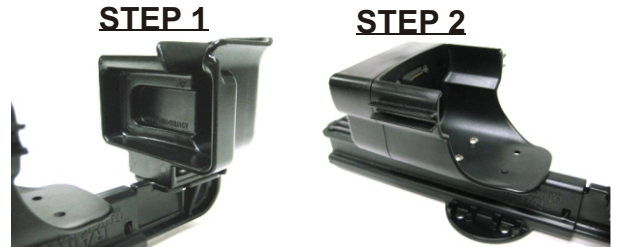

TENSION ADJUSTMENT

RAM Mounting Systems

8410 Dallas Ave S
Seattle, WA 98108
Phone: (206) 763-8361
Fax: (206) 763-9615
www.rammount.com
support@rammount.com



This document, including images, may not be reproduced partly or fully without the expressed written consent of National Products, Inc.

RAM® QUICK DRAW™ ASSEMBLY INSTRUCTIONS (SIDE B)

ATTACHING WIRE CLIP

REMOVE SCREW ABOVE USB PORT, SNAP POWER CORD IN WIRE CLIP, AND RE-INSERT SCREW TO SECURE POWER CORD THROUGH WIRE CLIP.



AVOID SHARP BENDS

WARNING: THIS PRODUCT IS DESIGNED TO BE MOUNTED WITH A GENUINE RAM® MOUNT. IT IS THE RESPONSIBILITY OF THE INSTALLER/END USER TO ENSURE THIS PRODUCT IS PROPERLY MOUNTED AND SECURED, AS TO AVOID FREE MOVEMENT ABOUT THE CAB OF THE VEHICLE OR SIMILAR INSTALLATION ENVIRONMENT. PLEASE USE ALL CABLE RETENTION FEATURES SUPPLIED WITH THIS PRODUCT, AND USE BEST PRACTICES IN WIRE ROUTING TO AVOID DAMAGE TO THE MOUNT OR MOUNTED DEVICE. NOT FOLLOWING THESE INSTRUCTIONS MAY VOID YOUR WARRANTY.

DOCKING INSTRUCTIONS

1. PLACE TOP END OF DEVICE INTO (C) TOP CUP. ENGAGE SPRING TENSION BY APPLYING UPWARD FORCE.

2. ONCE UPWARD FORCE IS APPLIED, THERE SHOULD BE AMPLE ROOM TO FIT ENTIRE DEVICE INTO DOCKING STATION WITHOUT MAKING CONTACT WITH (B) DOCKING CUP. ALIGN BOTTOM OF DEVICE WITH GROOVES IN (B) DOCKING CUP.

3. ONCE ALIGNED, ALLOW SPRING TENSION TO ENGAGE YOUR DEVICE WITH DOCKING CONNECTOR PINS ON (B) DOCKING CUP.

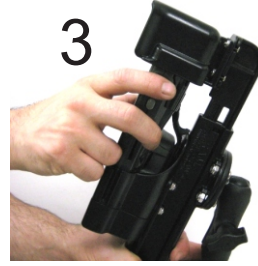
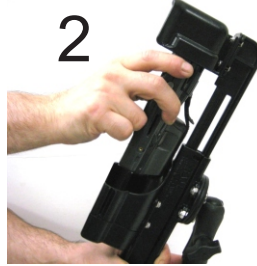

RAM Mounting Systems
8410 Dallas Ave S
Seattle, WA 98108
Phone: (206) 763-8361
Fax: (206) 763-9615
www.rammount.com
support@rammount.com



This document, including images, may not be reproduced partly or fully without the expressed written consent of National Products, Inc.

RAM® QUICK DRAW™ ASSEMBLY INSTRUCTIONS (SIDE B)

ATTACHING WIRE CLIP

REMOVE SCREW ABOVE USB PORT, SNAP POWER CORD IN WIRE CLIP, AND RE-INSERT SCREW TO SECURE POWER CORD THROUGH WIRE CLIP.



AVOID SHARP BENDS

WARNING: THIS PRODUCT IS DESIGNED TO BE MOUNTED WITH A GENUINE RAM® MOUNT. IT IS THE RESPONSIBILITY OF THE INSTALLER/END USER TO ENSURE THIS PRODUCT IS PROPERLY MOUNTED AND SECURED, AS TO AVOID FREE MOVEMENT ABOUT THE CAB OF THE VEHICLE OR SIMILAR INSTALLATION ENVIRONMENT. PLEASE USE ALL CABLE RETENTION FEATURES SUPPLIED WITH THIS PRODUCT, AND USE BEST PRACTICES IN WIRE ROUTING TO AVOID DAMAGE TO THE MOUNT OR MOUNTED DEVICE. NOT FOLLOWING THESE INSTRUCTIONS MAY VOID YOUR WARRANTY.

DOCKING INSTRUCTIONS

1. PLACE TOP END OF DEVICE INTO (C) TOP CUP. ENGAGE SPRING TENSION BY APPLYING UPWARD FORCE.

2. ONCE UPWARD FORCE IS APPLIED, THERE SHOULD BE AMPLE ROOM TO FIT ENTIRE DEVICE INTO DOCKING STATION WITHOUT MAKING CONTACT WITH (B) DOCKING CUP. ALIGN BOTTOM OF DEVICE WITH GROOVES IN (B) DOCKING CUP.

3. ONCE ALIGNED, ALLOW SPRING TENSION TO ENGAGE YOUR DEVICE WITH DOCKING CONNECTOR PINS ON (B) DOCKING CUP.



RAM Mounting Systems
8410 Dallas Ave S
Seattle, WA 98108
Phone: (206) 763-8361
Fax: (206) 763-9615
www.rammount.com
support@rammount.com



This document, including images, may not be reproduced partly or fully without the expressed written consent of National Products, Inc.