

W

W 55 mm

H 110 mm



User Manual

iPad Special Active Stylus



Product Details

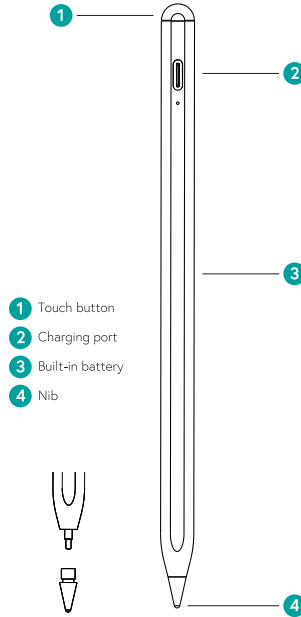

- 1 Touch button
- 2 Charging port
- 3 Built-in battery
- 4 Nib



How to Charge

You can charge the stylus in below 3 methods:

1. Charge via Computer or Tablet.
2. Charge via 5V/1A USB charger.
3. Charge via Power Bank.

Connect type-C end with stylus charging port
Connect another end with USB port of Computer/
Tablet/USB charger/Power Bank.

When charging, indicator shows red, it takes 60-80 minutes. After full charge, indicator shows green.

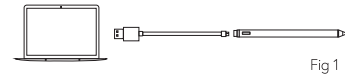

Fig 1



Fig 2

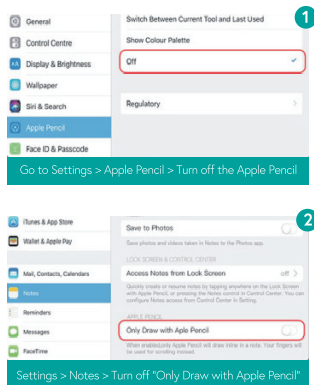

Fig 3

How to connect

Please follow these steps to make sure the Active Stylus is allowed to work on your iPad or iPad Pro:

1. Go to Settings > Apple Pencil > Turn off the Apple Pencil. Settings > Notes > Turn off "Only Draw with Apple Pencil".
2. Please turn off the Bluetooth connection before using your new stylus pen if you have connected the "apple pencil". No need to install Bluetooth.
3. ALL iPad IOS systems must be updated to iOS 12.2 or above.
4. It will be a better user experience if used with the tempered glass screen protector.
5. Please ensure it has enough power before use and notice that there is NO press sensitivity, all lines are at the same thickness.



Product Specifications

| | |
|--------------------|--|
| Model name | iPad Special Active Stylus |
| Main functions | Drawing/Writing/Touch-Control |
| Material | Aluminum Body (POM plastic) |
| Dimension | Nib \varnothing 1.0 mm; Body \varnothing 8.9 mm |
| Working time | 8-10 hour |
| Product colors | White |
| Battery model | 68430 |
| Accessory | USB Type C Charging Cable |
| Compatible Devices | Designed for Apple iPad/Pro/Mini/Air 2018 and later released version |
| Packaging | Charging Cable; User Manual |
| Function | Palm rejection/Magnetic/Tilt Support |

Compatible Models

| Model | Model number | Software ver. | Release | Screen size |
|-------------|-------------------------|---------------|---------|-------------|
| iPad 6 | A1893/A1954 | 12.1.4 - 12.3 | 2018 | 9.7 |
| iPad Mini 5 | A2133/A2124/A2126/A2125 | 12.2 - 12.3 | 2019 | 7.9 |
| iPad Air 3 | A2152/A2123/A2153/A2154 | 12.2 - 12.3 | 2019 | 10.5 |
| iPad Pro | A1980/A2013/A1934/A1979 | 12.2 - 12.3 | 2018 | 11 |
| iPad Pro 3 | A1876/A2014/A1895/A1983 | 12.2 - 12.3 | 2018 | 12.9 |
| iPad 7 | A2197/A2198/A2200 | 13.1 | 2019 | 10.2 |
| iPad Pro | A2268/A2231 | 13.4 | 2020 | 11 |
| iPad Pro 4 | A2229/A2233 | 13.4 | 2020 | 12.9 |
| iPad B | A2270/A2498/A2499/A2430 | 14.2 | 2020 | 10.2 |
| iPad Air 4 | A2316/A2325 | 14.2 | 2020 | 10.9 |
| iPad Pro | A2301/A2459/A2460 | | 2021 | 11 |
| iPad Pro | A2376/A2461/A2462 | | 2021 | 12.9 |